

## Installation

### 1. Pre Installation

1. If required, use a suitable compound to fill in any cracks or holes in the subfloor. Ensure the surface is structurally sound, clean, and dry. Floor must be level to 4.7mm per 3m radius. Maximum deflection should be no more than 1.1mm.
2. Make sure a 4mm space must be left between walls and other obstructions such as pipes, stairs, pillars, etc. Trim mouldings can be used to cover these spaces after installation is complete. When measuring to install around pipes, drill holes 12mm larger than pipes.
3. When possible avoid placing joints of RCV over the top of joints/seams of subfloor. End joints of boards should be staggered at least 18cm apart. Plan layout such that beginning and end of rows are greater than 30cm in length. Also check layout before beginning installation for planned width of final row: this should not be less than 5cm. If so, make adjustments to width of first row so that both first and last will be wider than 5cm.
4. Do not install over expansion joints.
5. Do not install kitchen cabinets or island directly over RCV flooring. Warranty will be voided if floor is unable to move freely for contraction and expansion during temperature changes.
6. Decide on direction floor is to be installed. It is recommended to install planks parallel to main source of light in the room.
7. Remove thresholds, baseboards, and skirting before fitting if necessary. If the pre-existing floor surface is smooth and flat, you may choose to skip this step (please see substrate requirements listed above). Door trim preparations vacuum/sweep installation area to remove debris and dust.

### 2. Installation

1. Once subfloor is fully cleaned and prepared, begin with laying planks left to right for first row. Place first plank so grooved edge is facing towards you. Place board 4mm from left wall. Use spacers between wall and plank.
2. For the second board in the first row, lay the board interlocking with the first end-to-end and tap gently with a rubber mallet to lock firmly together. These should be same height if laid properly. Ensure both are perfectly aligned. Continue in the same method towards right hand wall. **Note:** If both boards are not same height or are not locked properly together follow the directions at bottom of guide of "To Uninstall". Remove board(s) and check for debris obstructing the lock and grooves. If the end joints are not properly lined up, trying to force the boards together will permanently damage end joints.
3. For final board of first row ensure to measure length required to allow 4mm gap for expansion between plank and right hand wall.

4. To cut board place facing upwards. Using a sharp utility knife and ruler, cut pushing firmly several times on the same line. This will not cut through the board, but will cut deeply. Then place one hand close to the cut and push down firmly, and use other hand to lift the other half of the plank. The board should split naturally at the cut mark.
5. Beginning the second row, use remainder of cut plank from last piece of first row, provided piece is minimum 30cm. Otherwise cut a new plank to begin this row, ensuring joints are at least 18cm apart. Use the remainder of cut plank for ends of rows so as to begin subsequent rows and whenever possible.
6. Click together the long sides of the new plank and the one in the previous row, placing the board slightly at an angle then pressing lightly down to fit into row with an angle of 30°. Drop the plank, and tap gently with a rubber mallet to lock firmly together. These should be same height if laid properly. Ensure both are perfectly aligned.
7. After installing 2 or 3 rows check the straightness using a string line. If the planks are not running straight, it may be caused by unevenness in the starting wall. The first row may require to be re-trimmed to adjust accordingly.
8. For final row, lay a plank of RCV directly on top of last completed row. Place another board on top, touching the tongued side of the plank against the final wall. Trace a line along the edge of this piece marking the first board. Then cut along the edge of this piece to mark the first board. Cut using this line to get required width of board. Insert this cut board against the final wall. The final row should be a minimum of 5cm in width. Spacers can then be removed.
9. When measuring the holes for pipes, use the diameter of the pipe and cut a hole 12cm larger. Holes for pipes: measure the diameter of the pipe and drill a hole that is 12cm larger. Saw off a piece, and install the board around the pipe. Then lay sawed-off piece of board in place.
10. When installation is complete, fit decorative moulding if desired allowing a slight clearance between moulding and RCV. Attach moulding to walls, not to the flooring. For areas where RCV meets other flooring types use appropriate door plate to cover exposed edges. Do not pinch RCV with moulding, and allow a small space between surfaces.

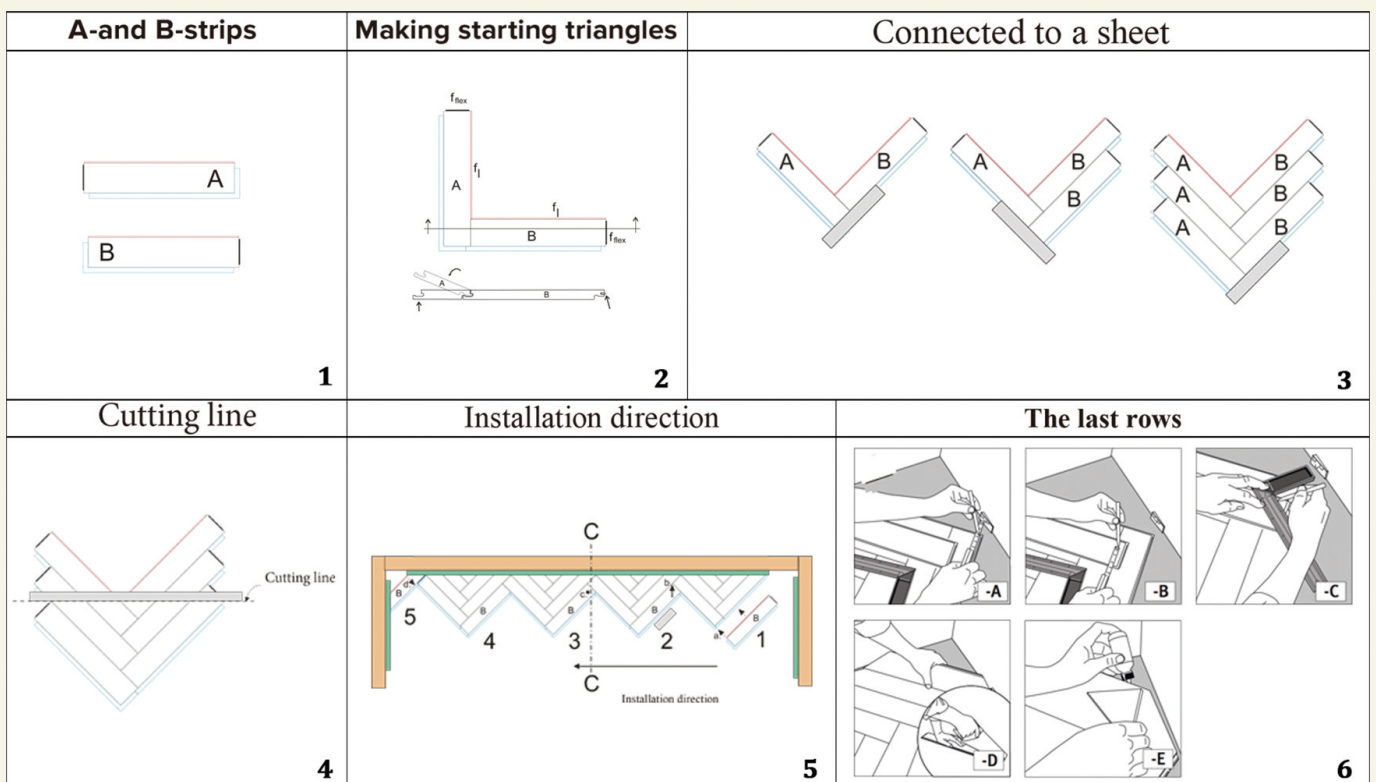

### 3. Homeowner Responsibilities

To maintain warranty coverage and ensure long-term performance, homeowner must:

- Confirm installation was done according to the **official Nordikka Herringbone SPC Installation Guide**.
- Use only **safe, vinyl-compatible cleaning products**.
- Retain **five spare planks** from the original installation batch for product testing if required.
- Keep a **copy of the original receipt** and installation date record.
- Avoid alterations that may compromise the floating installation system, such as gluing planks down or pinning mouldings through the floor.

### 4. To Uninstall

Lift an entire row of RCV carefully and gently at an angle. To remove individual boards leave flat on ground and slide them apart. If boards do not separate easily lift the plank at a slight angle when sliding apart.